



Flat, Coombe Lane, Raynes Park

£475,000

Summary

**** PRIVATE BALCONY****

Brinkley's Estate Agents are delighted to offer this stunning two bedroom modern build apartment, which comes with its own private balcony. Located right in the heart of Raynes Park centre, 0.1 miles from the mainline station. Property briefly comprises of open lounge kitchen area, high quality fitted kitchen with integrated appliances, two double bedrooms and top spec bathroom. Further benefits include communal roof terrace, long lease, underfloor heating & wooden flooring. If you would like to view, please contact Brinkley's Estate Agents on 0208 944 2918. Sole Agents.

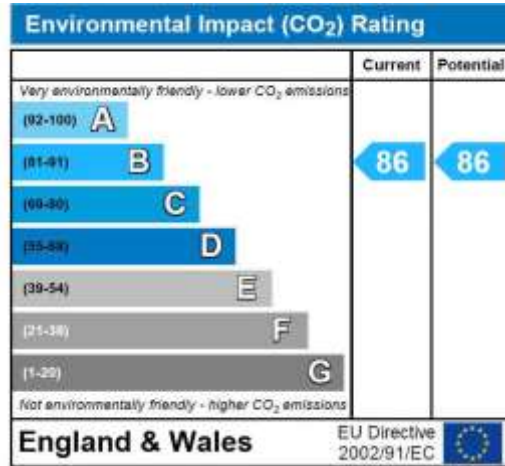
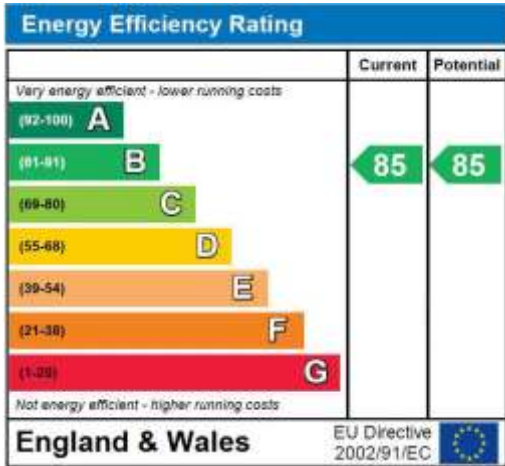

Coombe Lane

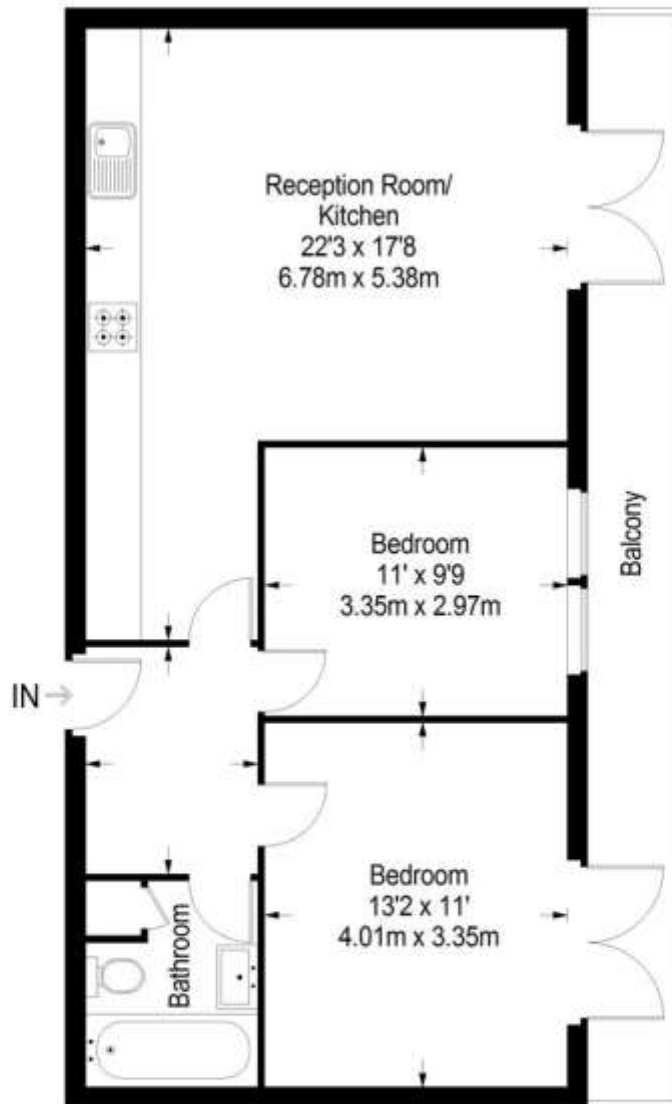

First Floor = 681 sq ft

Approximate Gross Internal Area
FIRST FLOOR = 681 sq ft / 63.26 sq m
Total = 681 sq ft / 63.26 sq m



This plan is for layout guidance only. Not drawn to scale unless stated. Windows and door openings are approximate. Whilst every care is taken in the preparation of this plan, please check all dimensions, shapes and compass bearings before making any decisions reliant upon them. (ID357409)