

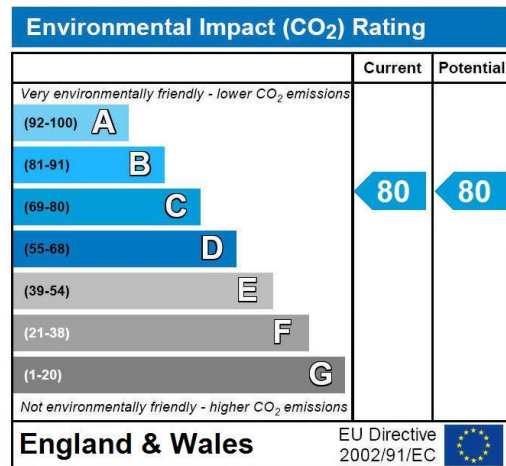

Flat, Pembroke House, Chaucer Way, Wimbledon
£425,000

Summary

Brinkley's Estate Agents are delighted to offer to the market this modern, purpose built, 2 bedroom top floor apartment in a popular gated development in Wimbledon. The accommodation comprises a sweeping hallway with fitted storage, a modernised bathroom suite, master double bedroom with en suite shower room, a second double bedroom with built-in wardrobe and a generously sized lounge/dining area and separate fully fitted kitchen. Further benefits include allocated parking space, security entrance phone, UPVC double glazing and internal space totalling 697 sq ft. Within easy reach of Wimbledon town centre, South Wimbledon tube, Colliers Wood tube, Haydons Road train station (direct into St Pancras, Blackfriars and Farringdon), the areas parks, commons and an abundance of social and recreational facilities. To view, please call Brinkley's on 0208 944 2918. Sole Agents.

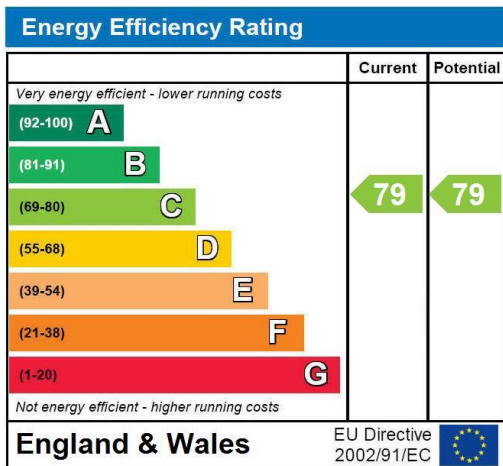

Pembroke House

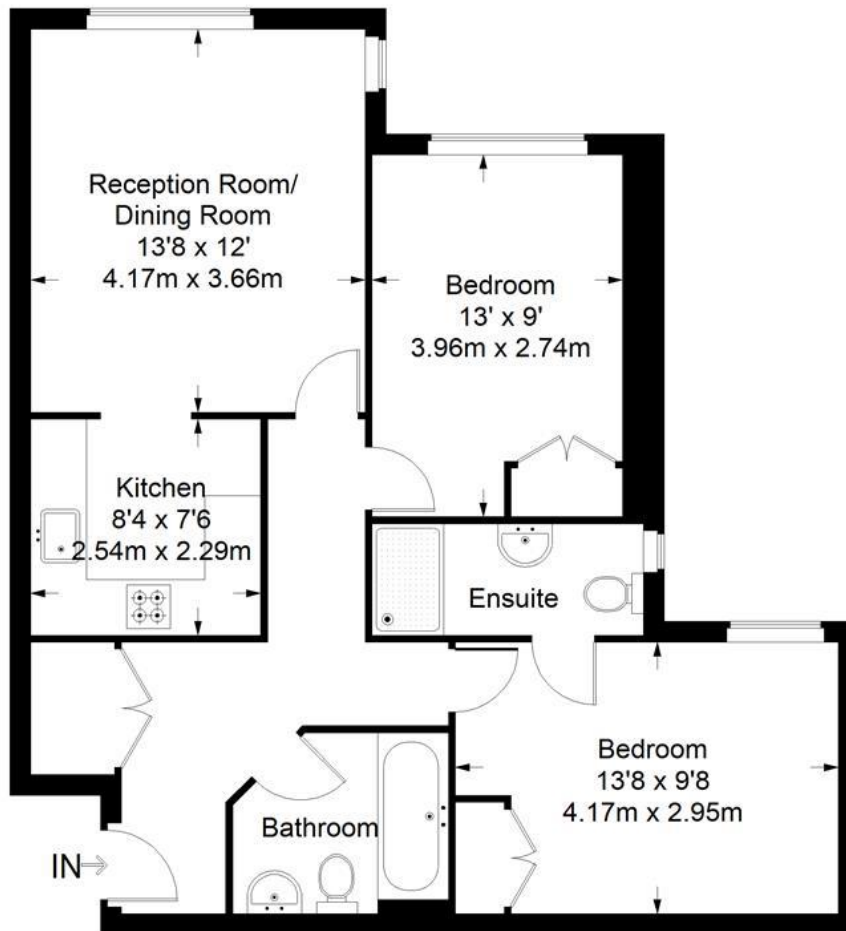

Second Floor = 699 sq ft

Approximate Gross Internal Area
Second Floor = 699 sq ft / 64.94 sq m
Total = 699 sq ft / 64.94 sq m



This plan is for layout guidance only. Not drawn to scale unless stated. Windows and door openings are approximate. Whilst every care is taken in the preparation of this plan, please check all dimensions, shapes and compass bearings before making any decisions reliant upon them. (ID357409)

