



Flat, Sherfield Gardens, Roehampton  
**£1,556 pcm**

**Summary**

NO TENANT FEES

ABOUT THE PROPERTY: Brinkley's of Putney are pleased to offer this superb, split-level apartment, located in the ever-popular Sherfield Gardens in Roehampton. With wooden floors throughout the ground floor and comprised of four double bedrooms, a large family bathroom and separate shower room, an open-plan kitchen/living area with plenty of storage throughout, this property is perfect for sharers or students. Also benefiting from Wandsworth Council Tax and only moments from Richmond Park.

**LOCATION:** The property benefits from being moments away from stunning rural parks and amazing views - a very quiet and peaceful location, transport links are very good and your only moments away from local bus routes.

**HOW TO VIEW:** Please call our Wimbledon Hill office on 020 8944 2918, our Wimbledon Park branch on 020 8879 3718 or our Putney office on 020 8785 3652, for more information and to arrange a viewing. Open 7 days a week. Viewings Mon- Fri 8-8, Weekends 9-6.

**Energy Efficiency Rating:** C



## Sherfield Gardens

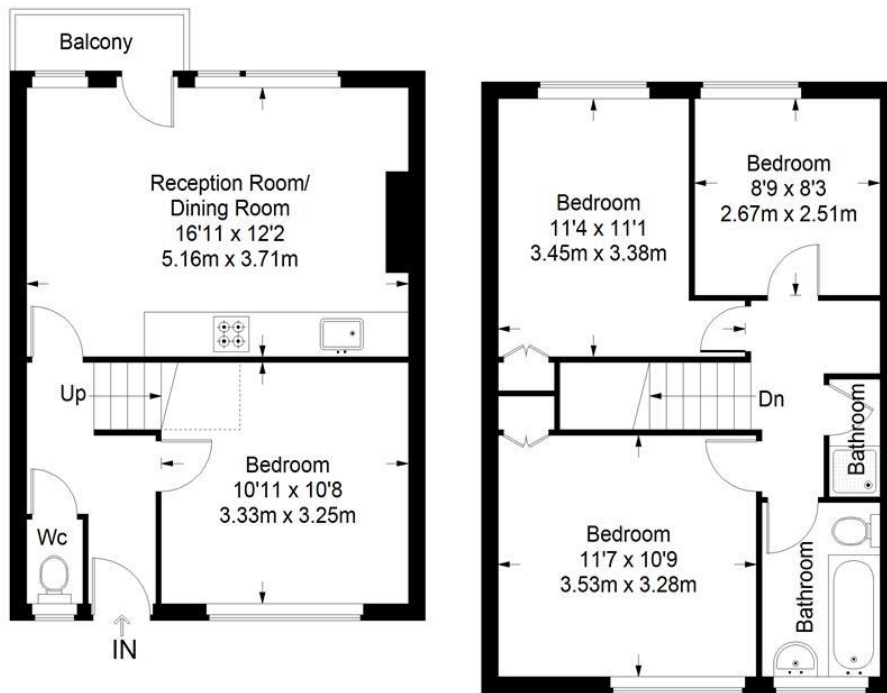

**First Floor = 394 sq ft**

**Second Floor = 438 sq ft**

Approximate Gross Internal Area  
 FIRST FLOOR = 394 sq ft / 36.60 sq m  
 SECOND FLOOR = 438 sq ft / 40.69 sq m  
 Total = 832 sq ft / 77.29 sq m



This plan is for layout guidance only. Not drawn to scale unless stated. Windows and door openings are approximate. Whilst every care is taken in the preparation of this plan, please check all dimensions, shapes and compass bearings before making any decisions reliant upon them. (ID357409)

