



Bodnant Gardens, Raynes Park
£450,000

Summary

About the property: Brinkley's Estate Agents are delighted to offer this spacious, three bedroom, family home with a private garden, conveniently located close to Raynes Park town centre. The property briefly comprises an entrance hall, modern kitchen/dining area, second reception room and a low maintenance private garden. First floor comprises three spacious bedrooms with plenty storage and family bathroom with shower facility. Further benefits include off-street parking, short distance to Waitrose supermarket, close to Raynes Park's social and recreational facilities.

How to view: Please contact our Wimbledon Hill office on 0208 944 2918, Wimbledon Park office on 0208 879 3718 or our Putney office on 0208 785 3652 for more information or to book a viewing. We are open from 8:30am - 7pm Monday to Friday and 9am - 6pm on weekends. Sole Agents.



Bodnant Gardens

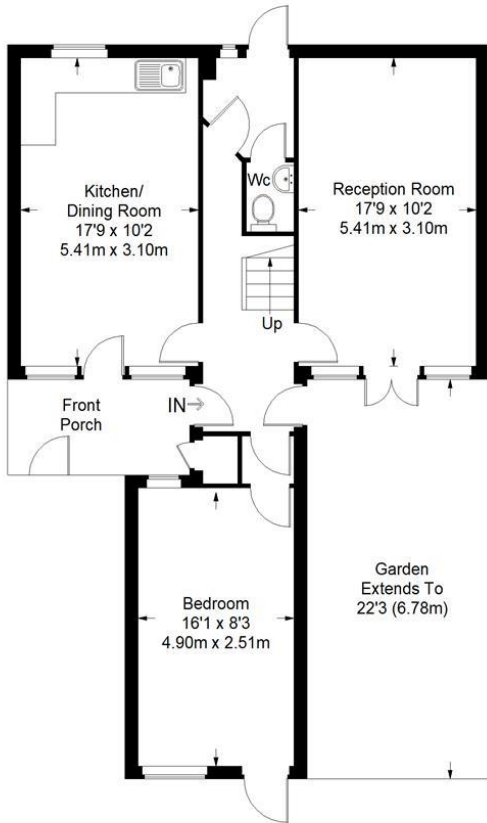

Ground Floor = 654 sq ft

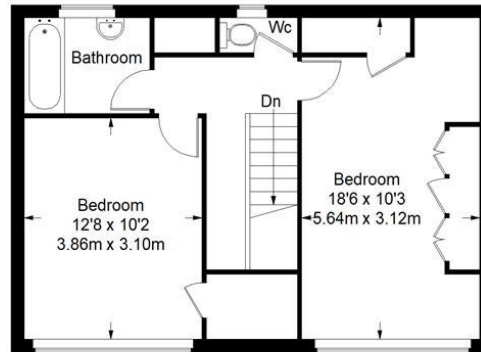

First Floor = 486 sq ft

Approximate Gross Internal Area
 GROUND FLOOR = 654 sq ft / 60.76 sq m
 FIRST FLOOR = 486 sq ft / 45.15 sq m
 Total = 1140 sq ft / 105.91 sq m



This plan is for layout guidance only. Not drawn to scale unless stated. Windows and door openings are approximate. Whilst every care is taken in the preparation of this plan, please check all dimensions, shapes and compass bearings before making any decisions reliant upon them. (ID357409)

