



Maisonette, Khartoum Road, Tooting  
**£280,000**

**Summary**

A fantastic opportunity to acquire a one bedroom upper maisonette situated on a peaceful residential road between Earlsfield and Tooting. The property has its own front door from the street. The property requires modernisation throughout but offers fantastic potential and has a private garden. Khartoum Road is a prime location within Tooting Broadway, only a short walk from Tooting Broadway Tube (Northern Line) and Earlsfield. It is also perfectly placed for St Georges Hospital/University, making this an ideal first time or buy to let purchase. Further benefits include no onward chain and potential to extend (STPP).

How to view: Please contact our Wimbledon Hill office on 0208 944 2918, Wimbledon Park office on 0208 879 3718 or our Putney office on 0208 785 3652 for more information or to book a viewing. We are open from 8:30am - 7pm Monday to Friday and 9am - 6pm on weekends. Sole Agents.

## Khartoum Road

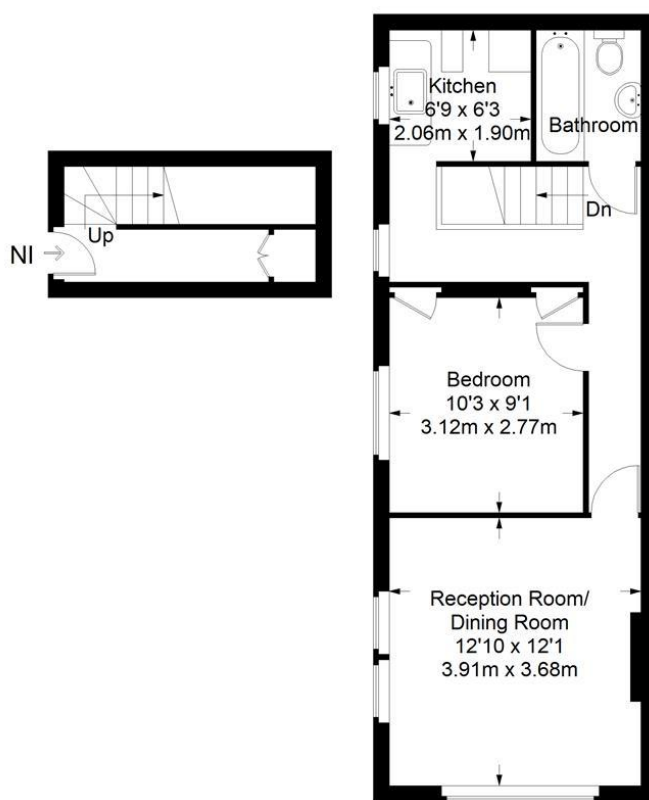

**Ground Floor = 67 sq ft**

**First Floor = 432 sq ft**

Approximate Gross Internal Area  
GROUND FLOOR = 67 sq ft / 6.22 sq m  
FIRST FLOOR = 432 sq ft / 40.13 sq m  
Total = 499 sq ft / 46.36 sq m



This plan is for layout guidance only. Not drawn to scale unless stated. Windows and door openings are approximate. Whilst every care is taken in the preparation of this plan, please check all dimensions, shapes and compass bearings before making any decisions reliant upon them. (ID357409)

