



Flat, Lockyer House, The Platt, Putney
£389,950

Summary

About the property: Briefly, this elegant flat consists of an open plan kitchen / living area which is all finished to a high standard. The large double bedroom boasts bags of light and built in storage.

Situated on the second floor there are stairs as well as a lift and access to the communal garden.

With parking available to the side and rear, Putney Bridge Station & Putney Rail Station are just moments away and it is just a minutes walk to Thames River and Putney High Street with all its amenities, bars and restaurants

Location: The Platt is a picturesque riverside location, which also The Lower Richmond Road and Putney High Street are within walking distance and offers a number of amenities including cafes, restaurants, bars and supermarkets. Excellent nearby transport links include Putney Bridge Underground station, the Thames River Taxi, and bus routes in to Central London.

How to view: Please contact our Wimbledon Hill office on 0208 944 2918, Wimbledon Park office on 0208 879 3718 or our Putney office on 0208 785 3652 for more information or to book a viewing. We are open from 8:30am - 7pm Monday to Friday and 9am - 6pm on weekends. Sole Agents.



Lockyer House

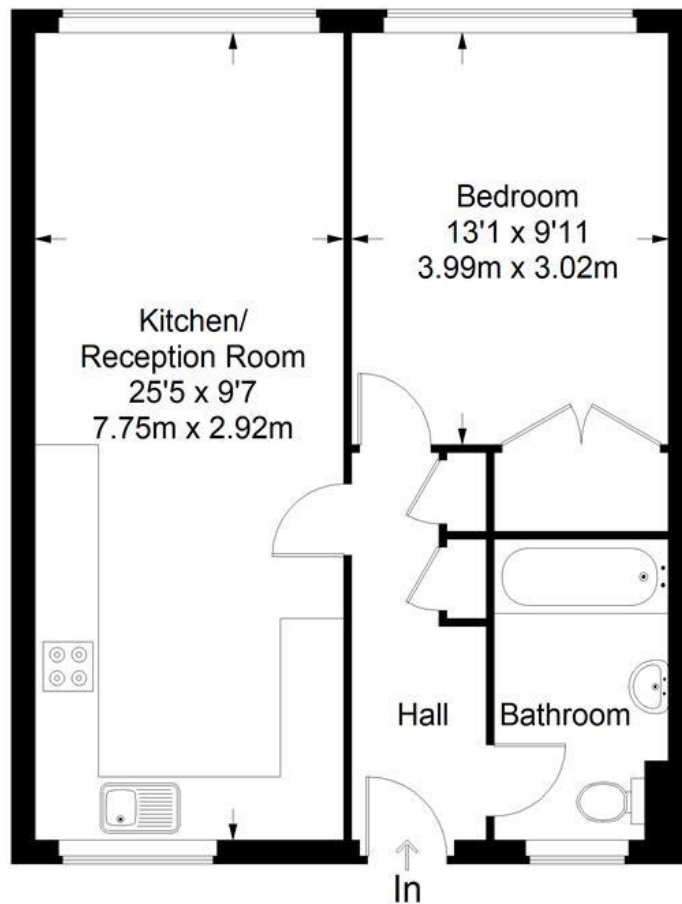

First Floor = 540 sq ft

Approximate Gross Internal Area
FIRST FLOOR = 540 sq ft / 50.16 sq m
Total = 540 sq ft / 50.16 sq m



This plan is for layout guidance only. Not drawn to scale unless stated. Windows and door openings are approximate. Whilst every care is taken in the preparation of this plan, please check all dimensions, shapes and compass bearings before making any decisions reliant upon them. (ID357409)

