



Flat, Kent Lodge, Inner Park Road, Southfields
£435,000

Summary

About the property: Recently, fully modernised to a high standard, positioned on the top floor. Offering over 750 sq ft of internal accommodation and spacious rooms with lovely views. Further benefits include no onward chain and a private garage.

Location: The property is situated in a ideal location for access to Putney, the A3 and Wimbledon Village. Walking distance from Southfields village and Tube station, with additional benefits including its close proximity to Wimbledon Park/Lake and the All England Tennis club and Wimbledon Common.



These particulars are intended to give a fair description of the property but their accuracy cannot be guaranteed, and they do not constitute an offer of contract. Intending purchasers must rely on their own inspection of the property. None of the above appliances/services have been tested by ourselves. We recommend purchasers arrange for a qualified person to check all appliances/services before legal commitment.

How to view: Please contact our Wimbledon Hill office on 0208 944 2918, Wimbledon Park office on 0208 879 3718 or our Putney office on 0208 785 3652 for more information or to book a viewing. We are open from 8:30am - 7pm Monday to Friday and 9am - 6pm on weekends. Sole Agents

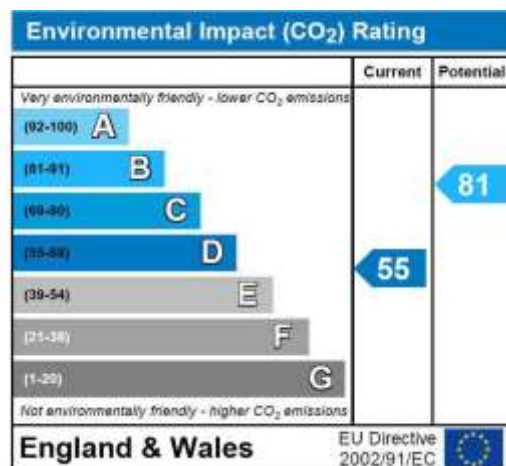
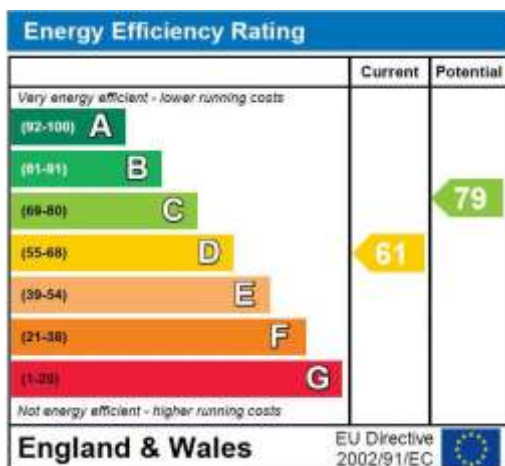

Kent Lodge

Approximate Gross Internal Area = 72.1 sq m / 776 sq ft

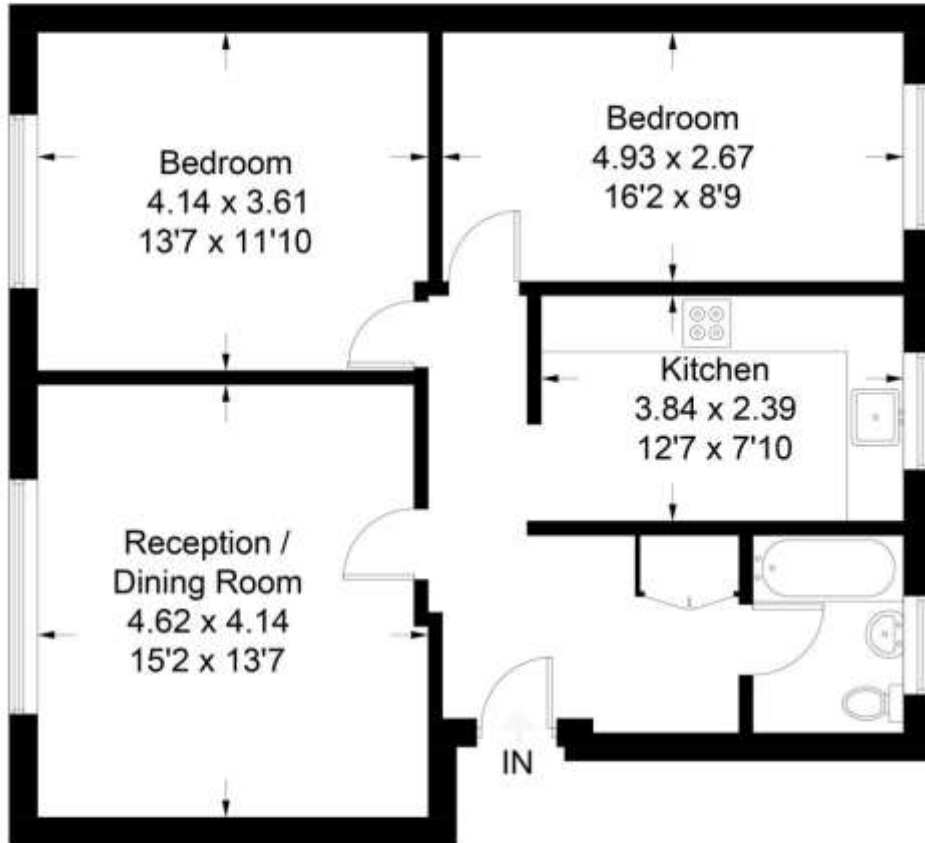

Third Floor

Illustration for identification purposes only, measurements are approximate, not to scale. floorplans4sketch.com © (ID527667)