



Maisonette, Ibsley Gardens, Roehampton
£325,000

Summary

Brinkley's Estate Agents are delighted to offer this purpose-built, top floor, three bedroom, maisonette located within easy reach of the green open spaces of Putney Heath and Richmond Park and Roehampton's local shopping/travelling facilities that include excellent local buses to Putney and Hammersmith. Briefly comprising a downstairs cloakroom, an open-plan kitchen/diner, a reception room, three bedrooms and bathroom/WC. Further benefits include double glazing and gas c/h. Ideal for first time or investment buyers. No chain. Early viewing recommended. Please contact Brinkley's in Putney on 0208 785 3652 to arrange a viewing.



Ibsley Gardens, SW15

Approximate Gross Internal Area = 82.8 sq m / 891 sq ft

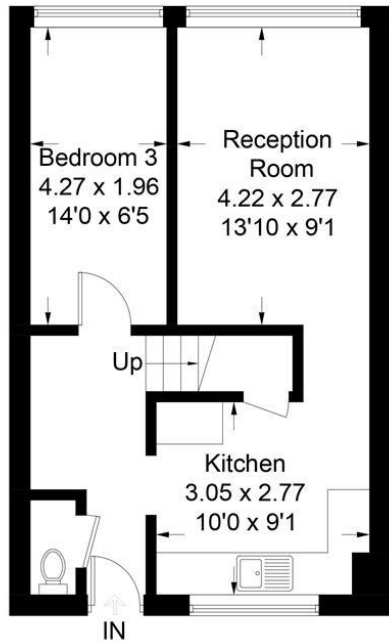

Second Floor

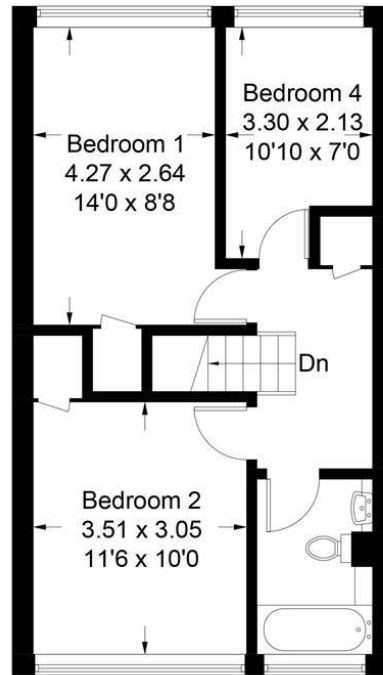

Third Floor

Illustration for identification purposes only, measurements are approximate, not to scale. FloorplansUsketch.com © 2018 (ID476870)

Energy Efficiency Rating		
	Current	Potential
Very energy efficient - lower running costs		
(92-100) A		
(81-91) B		
(69-80) C		
(55-68) D		
(39-54) E	52	
(21-38) F		
(1-20) G		
Not energy efficient - higher running costs		69
England & Wales	EU Directive 2002/91/EC	

Environmental Impact (CO ₂) Rating		
	Current	Potential
Very environmentally friendly - lower CO ₂ emissions		
(92-100) A		
(81-91) B		
(69-80) C		
(55-68) D		
(39-54) E	45	
(21-38) F		
(1-20) G		
Not environmentally friendly - higher CO ₂ emissions		66
England & Wales	EU Directive 2002/91/EC	