



Hilsea Point, Wanborough Drive, Roehampton
£300,000

Summary

Brinkley's Estate Agents are delighted to offer this beautifully-presented, purpose-built, second floor, flat, to the market. Situated within the popular, Alton Estate development and positioned between Richmond Park, Putney Heath and Wimbledon Common. The property comprises an entrance hall, with fitted storage cupboards, two double bedrooms with ample storage, a separate bathroom, and a modern fully-fitted kitchen. Further benefits include a long lease and a

149 Arthur Road, Wimbledon Park, SW19 8AB
168 Putney High Street, Putney, SW15 1RS
120 Wimbledon Hill Road, Wimbledon, SW19 7QU

T: 020 8879 3718
T: 020 8785 3652
T: 020 8944 2918



These particulars are intended to give a fair description of the property but their accuracy cannot be guaranteed, and they do not constitute an offer of contract. Intending purchasers must rely on their own inspection of the property. None of the above appliances/services have been tested by ourselves. We recommend purchasers arrange for a qualified person to check all appliances/services before legal commitment.



modern combi-boiler. The property is situated close to 24-hour, local bus routes, Southfields Underground Station (2.7 miles) and Putney Mainline Station (2.37 miles), offering easy access to central London. If you would like to view this property, please contact our Putney branch on 0208 785 3652. Sole Agents.



149 Arthur Road, Wimbledon Park, SW19 8AB
168 Putney High Street, Putney, SW15 1RS
120 Wimbledon Hill Road, Wimbledon, SW19 7QU

T: 020 8879 3718
T: 020 8785 3652
T: 020 8944 2918



These particulars are intended to give a fair description of the property but their accuracy cannot be guaranteed, and they do not constitute an offer of contract. Intending purchasers must rely on their own inspection of the property. None of the above appliances/services have been tested by ourselves. We recommend purchasers arrange for a qualified person to check all appliances/services before legal commitment.

Hilsea Point, SW15

Approximate Gross Internal Area = 66.2 sq m / 712 sq ft

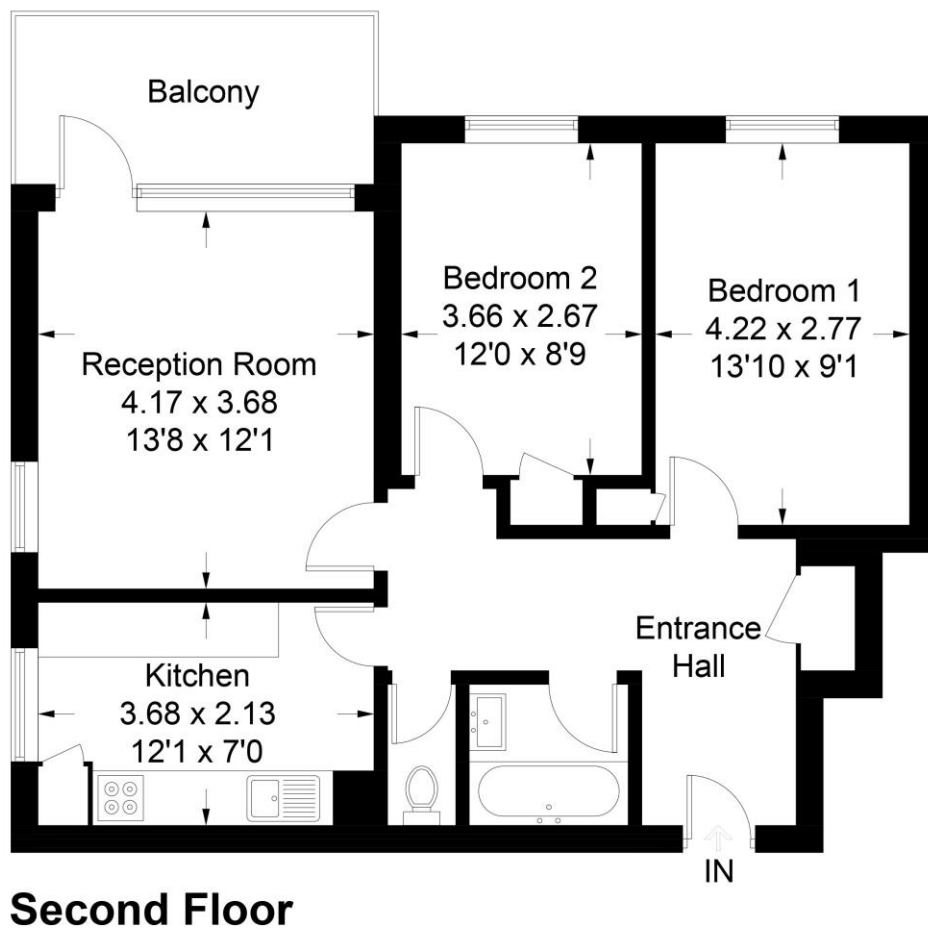

Illustration for identification purposes only, measurements are approximate, not to scale. FloorplansUsketch.com © 2018 (ID407535)

149 Arthur Road, Wimbledon Park, SW19 8AB
168 Putney High Street, Putney, SW15 1RS
120 Wimbledon Hill Road, Wimbledon, SW19 7QU

T: 020 8879 3718
T: 020 8785 3652
T: 020 8944 2918



These particulars are intended to give a fair description of the property but their accuracy cannot be guaranteed, and they do not constitute an offer of contract. Intending purchasers must rely on their own inspection of the property. None of the above appliances/services have been tested by ourselves. We recommend purchasers arrange for a qualified person to check all appliances/services before legal commitment.

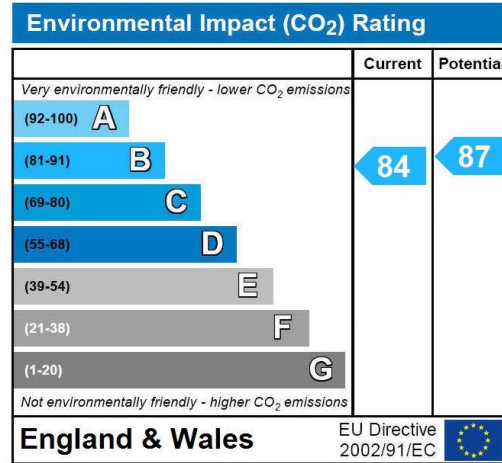
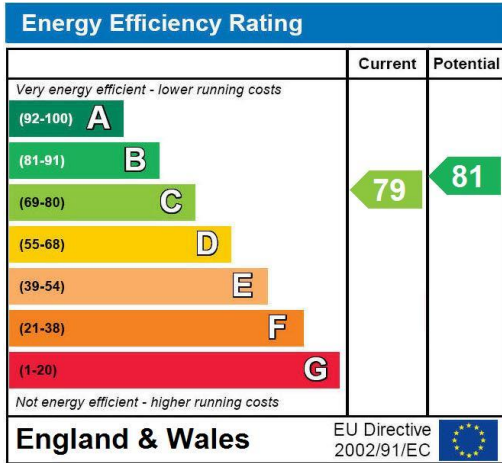

149 Arthur Road, Wimbledon Park, SW19 8AB
 168 Putney High Street, Putney, SW15 1RS
 120 Wimbledon Hill Road, Wimbledon, SW19 7QU

T: 020 8879 3718
 T: 020 8785 3652
 T: 020 8944 2918



These particulars are intended to give a fair description of the property but their accuracy cannot be guaranteed, and they do not constitute an offer of contract. Intending purchasers must rely on their own inspection of the property. None of the above appliances/services have been tested by ourselves. We recommend purchasers arrange for a qualified person to check all appliances/services before legal commitment.