



Kent Lodge, Inner Park Road, Southfields

£450,000

Summary

Brinkley's Estate Agents are pleased to present this bright, two bedroom, top floor flat on Inner Park Road in Southfields. The property is situated in a ideal location for access to Putney, the A3 and Wimbledon Village. The apartment comprises two double bedrooms, spacious living room with double glazed windows, modern fitted kitchen and large bathroom.

149 Arthur Road, Wimbledon Park, SW19 8AB

T: 020 8879 3718

168 Putney High Street, Putney, SW15 1RS

T: 020 8785 3652

120 Wimbledon Hill Road, Wimbledon, SW19 7QU

T: 020 8944 2918

1 Lambton Road, Raynes Park, SW20 0LW

T: 020 3817 6888



These particulars are intended to give a fair description of the property but their accuracy cannot be guaranteed, and they do not constitute an offer of contract. Intending purchasers must rely on their own inspection of the property. None of the above appliances/services have been tested by ourselves. We recommend purchasers arrange for a qualified person to check all appliances/services before legal commitment.



Further benefits include private garage, communal gardens and off street parking. Please call our Wimbledon Hill Office on 020 8944 2918, Wimbledon Park on 020 8879 3718 or our Putney Office on 020 8785 3652. Sole Agents.

EPC:TBC



149 Arthur Road, Wimbledon Park, SW19 8AB
168 Putney High Street, Putney, SW15 1RS
120 Wimbledon Hill Road, Wimbledon, SW19 7QU
1 Lambton Road, Raynes Park, SW20 0LW

T: 020 8879 3718
T: 020 8785 3652
T: 020 8944 2918
T: 020 3817 6888

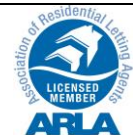

These particulars are intended to give a fair description of the property but their accuracy cannot be guaranteed, and they do not constitute an offer of contract. Intending purchasers must rely on their own inspection of the property. None of the above appliances/services have been tested by ourselves. We recommend purchasers arrange for a qualified person to check all appliances/services before legal commitment.

Kent Lodge, SW19



Approximate Gross Internal Area = 72.9 sq m / 785 sq ft

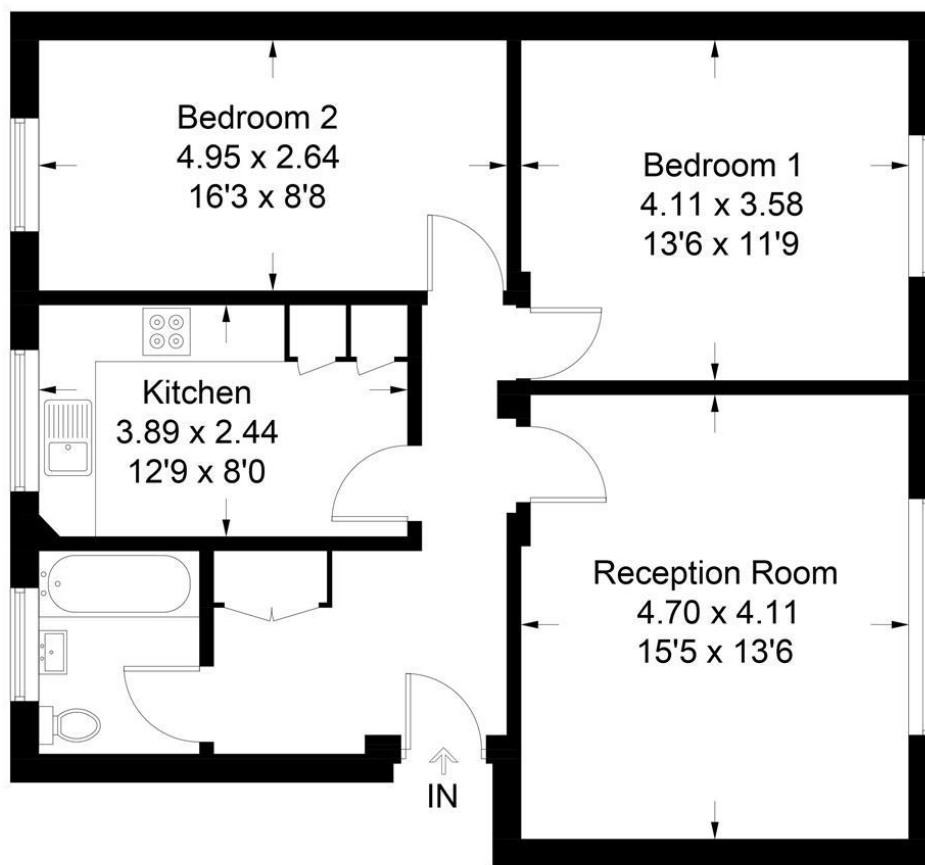

Third Floor

Illustration for identification purposes only, measurements are approximate, not to scale. FloorplansUsketch.com © 2017 (ID371840)

149 Arthur Road, Wimbledon Park, SW19 8AB
 168 Putney High Street, Putney, SW15 1RS
 120 Wimbledon Hill Road, Wimbledon, SW19 7QU
 1 Lambton Road, Raynes Park, SW20 0LW

T: 020 8879 3718
 T: 020 8785 3652
 T: 020 8944 2918
 T: 020 3817 6888

