



Flat, Arnal Crescent, Southfields

£320,000

Summary

Brinkley's Estate Agents are pleased to present this spacious, two bedroom, apartment in Arnal Crescent in Southfields. The property is within walking distance of Southfields Underground Station (District Line) and excellent bus links. The property comprises a large, double reception area to an open-plan, fitted kitchen, two large, double bedrooms and a bathroom (bath, shower, W.C. and sink) and off-street parking. Further benefits include no onward chain, ideal for first time buyers or buy to let investors. Please call our Wimbledon Park office on 020 8879 3718, Wimbledon Hill on 020 8944 2918 or our Putney office on 020 8785 3652.



Arnal Crescent

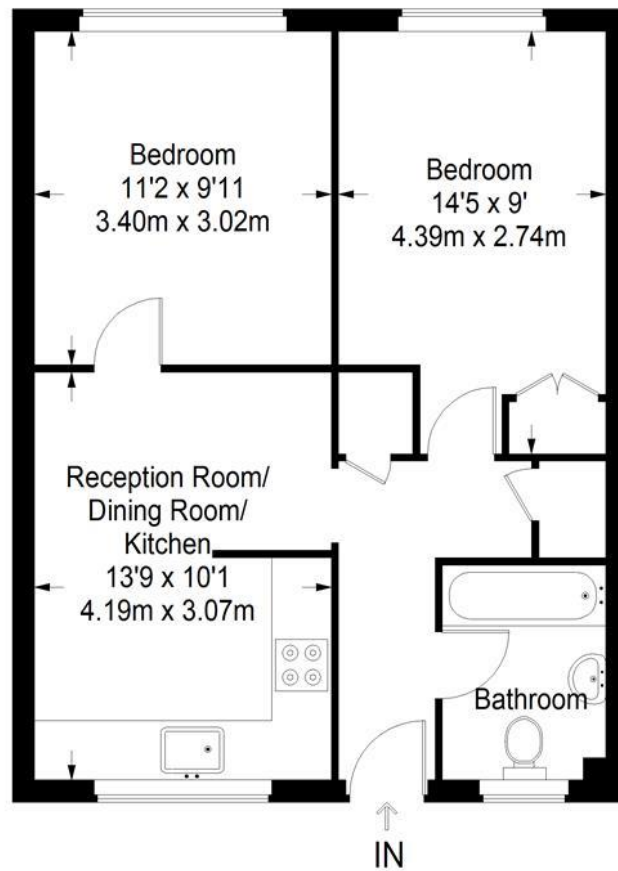

First Floor = 487 sq ft

Approximate Gross Internal Area
FIRST FLOOR = 487 sq ft / 45.24 sq m
Total = 487 sq ft / 45.24 sq m



This plan is for layout guidance only. Not drawn to scale unless stated. Windows and door openings are approximate. Whilst every care is taken in the preparation of this plan, please check all dimensions, shapes and compass bearings before making any decisions reliant upon them. (ID357409)

