



Flat, Seymour Road, Southfields  
**£1,450 pcm**

**Summary**

ABOUT THE PROPERTY: Brinkley's Estate Agents are delighted to offer to the market this fully modernised and fully furnished, to a high standard, first floor purpose-built apartment. Benefits include a modern fitted kitchen, bedroom and modern bathroom/WC as well as access to off-street parking, a large storage cupboard and an external storage shed. This property would best suit a professional couple or single occupant. Located on a quiet residential street, close to Southfield's tube station, with easy access to the A3.

HOW TO VIEW: Please call our Wimbledon Hill office on 020 8944 2918, our Wimbledon Park branch on 020 8879 3718 or our Putney office on 020 8785 3652, for more information and to arrange a viewing. Open 7 days a week. Viewings Mon- Fri 8-8, Weekends 9-6.

Energy Efficiency Rating: C



These particulars are intended to give a fair description of the property but their accuracy cannot be guaranteed, and they do not constitute an offer of contract. Intending purchasers must rely on their own inspection of the property. None of the above appliances/services have been tested by ourselves. We recommend purchasers arrange for a qualified person to check all appliances/services before legal commitment.



# First Floor

Approx. 46.1 sq. metres (496.3 sq. feet)

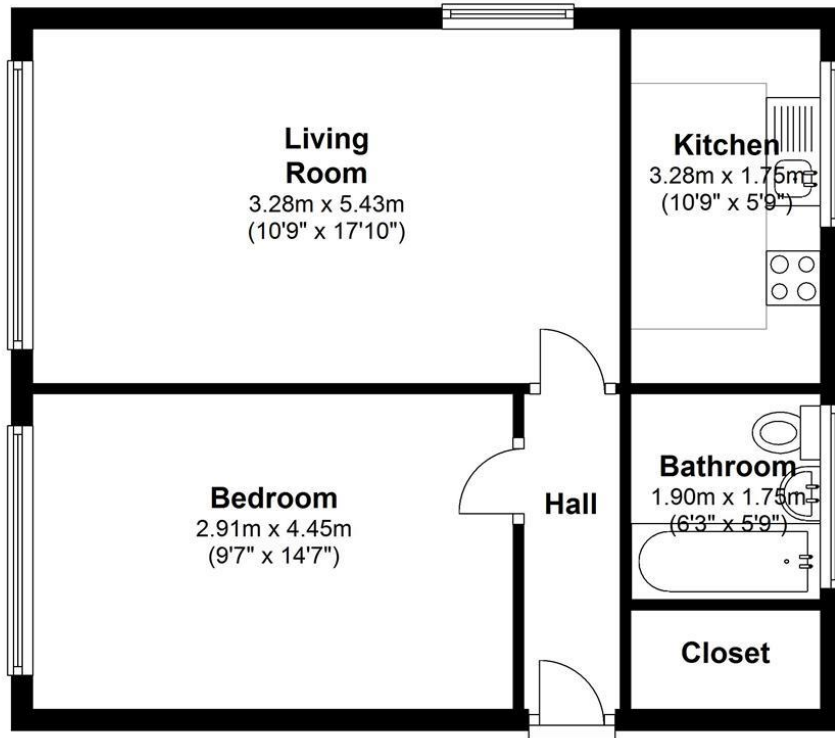

Total area: approx. 46.1 sq. metres (496.3 sq. feet)

Energy Efficiency Rating		
	Current	Potential
Very energy efficient - lower running costs		
(92-100) <b>A</b>		
(81-91) <b>B</b>		
(69-80) <b>C</b>		
(55-68) <b>D</b>		
(39-54) <b>E</b>		
(21-38) <b>F</b>		
(1-20) <b>G</b>		
Not energy efficient - higher running costs		
	<b>70</b>	<b>78</b>
<b>England &amp; Wales</b>	EU Directive 2002/91/EC	

Environmental Impact (CO <sub>2</sub> ) Rating		
	Current	Potential
Very environmentally friendly - lower CO <sub>2</sub> emissions		
(92-100) <b>A</b>		
(81-91) <b>B</b>		
(69-80) <b>C</b>		
(55-68) <b>D</b>		
(39-54) <b>E</b>		
(21-38) <b>F</b>		
(1-20) <b>G</b>		
Not environmentally friendly - higher CO <sub>2</sub> emissions		
	<b>72</b>	<b>83</b>
<b>England &amp; Wales</b>	EU Directive 2002/91/EC	