



Flat, Conifer Court, Inner Park Road, Wimbledon
£429,950

Summary

Brinkley's Estate Agents are delighted to offer this beautifully presented, two bed, two bath apartment. Located within a private gated development close to Wimbledon Common and Southfields Village. Property briefly comprises an entrance hall with storage cupboards, family bathroom with shower, second double bedroom, master bedroom with modernised shower room and direct access to private balcony, spacious lounge with feature fireplace and French doors, leading to private balcony and separate fitted kitchen with integrated appliances. Further benefits include share of freehold, off street parking and well presented, communal gardens.

If you would like to view, please contact Brinkleys Estate Agents on 0208 879 3718. Sole Agents.

EPC: TBC



Inner Park Road, London, SW19

APPROX. GROSS INTERNAL FLOOR AREA 624 SQ FT 57.9 SQ METRES

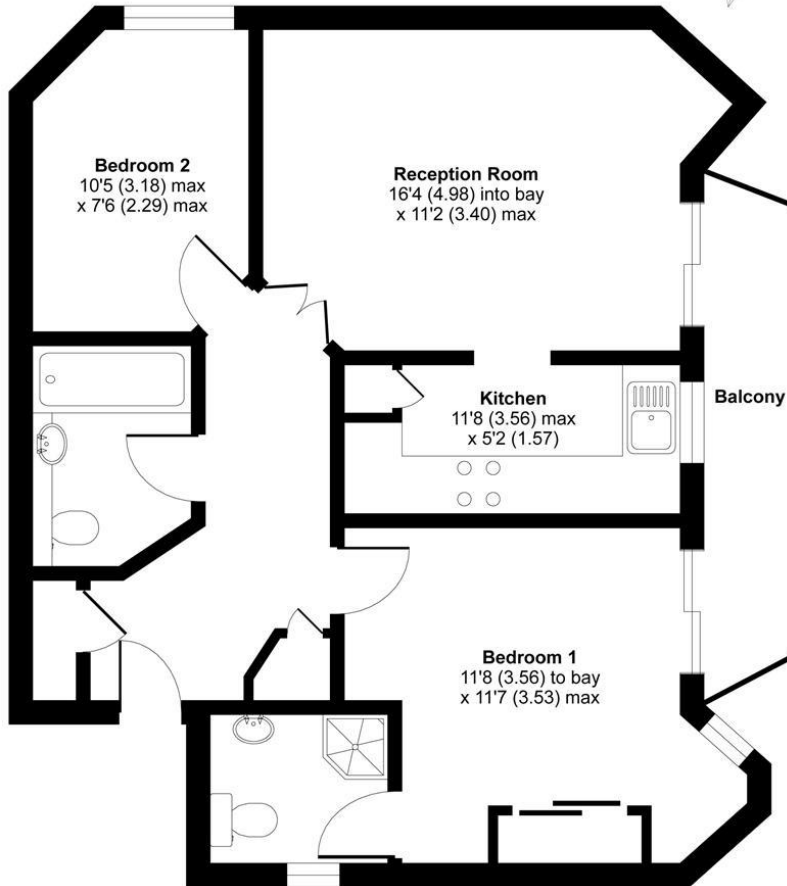

GROUND FLOOR

Whilst every attempt has been made to ensure the accuracy of the floor plan contained here, measurements of doors, windows and rooms are approximate and no responsibility is taken for any error, omission or misstatement. These plans are for representation purposes only as defined by RICS Code of Measuring Practice and should be used as such by any prospective purchaser. Specifically no guarantee is given on the total square footage of the property if quoted on this plan. Any figure given is for initial guidance only and should not be relied on as a basis of valuation.

Copyright nichecom.co.uk 2015 Produced for Brinkleys