



£249,500

14 Victoria Road, Port St Mary, IM9 5AF

A Modern Mid Terrace 4 Bed Family House in the Heart of the Village. Walking Distance to Shops, Beach, Primary School & Restaurants. Exceptionally Spacious Accommodation & Modern Cavity Construction. Briefly Comprising 21'5 Lounge/Dining Room & Large Kitchen/Diner. 1st Floor 2 Excellent Double Bedrooms, 1 with Fitted Furniture. Large Family Bathroom with a Modern White 4 Piece Suite. 2nd Floor 2 Further Double Bedrooms & Potential for Shower Room. Easily Accessible Eaves Storage Areas. Oil Fired Central Heating & uPVC Windows with Timber Framed 'Velux's'. Low Maintenance Front & Enclosed Rear Garden. Communal Block Paved Area to the Rear Providing 2 Parking Spaces.



*** INTERIOR INSPECTION RECOMMENDED IN ORDER TO FULLY APPRECIATE ***

DIRECTIONS

From the Four Roads roundabout in Port Erin take the exit marked Port St Mary, continuing over the railway crossing past the primary school. Victoria Road will be found a short distance along on the right hand side, ideally located with good access to the beach and village shops. Number 14 will be found towards the top on the right hand side, being clearly numbered and one of three similar modern terraced houses.

ACCOMMODATION

GROUND FLOOR

Part obscure glazed uPVC entrance door.

Entrance Area

Stairs lead off to the upper floors. Electric consumer unit. Door to the lounge.

Lounge/Diner 4.24m (13'11") x 6.53m (21'5")

An exceptionally spacious room with a large uPVC bay window to the front. Featuring a traditionally styled electric fire with a brushed steel surround and polished hearth. Coved ceiling. Wall lights. TV and satellite points.



Register on our Mailing List for ...

Lounge/ Diner Cont'd



Kitchen Diner 5.23m (17'2") x 3.38m (11'1")

A naturally bright and spacious room fitted with a good range of white contour fronted units together with drawers and built in wine racks. Laminate work surfaces incorporate a single drainer sink with mixer tap. Built in electric double oven and inset 4 ring gas hob with a filter hood over. Space for an American style fridge. Space for dishwasher. Oil fired boiler. Background tiling. Two uPVC double glazed windows and a half glazed uPVC door. Wall mounting for a TV. Ceiling spotlights. Space for a table and chairs. Deep set cupboard with light and plumbing for a washing machine. Telephone point.



Register on our Mailing List for ...

FIRST FLOOR

Landing 1.78m (5'10") x 5.23m (17'2")

Stairs continue to the second floor. Front uPVC window. Power point. Smoke detector.



Bathroom 3.56m (11'8") x 2.03m (6'8")

An exceptionally spacious, fully tiled room fitted with a contemporary styled white suite comprising panelled bath, vanity unit with top mounted basin, WC with concealed cistern and a glazed corner enclosure housing a fully plumbed shower. Mirror fronted vanity unit. Chrome ladder style towel warmer. Easy care ceiling with inset down lights. Obscure glazed uPVC window. Shaver point. Tiled floor.



Register on our Mailing List for ...

Bedroom 2 4.72m (15'6") x 3.05m (10'0")

A superb double room with ample space for a super king size bed if required. A uPVC window enjoys pleasant rear facing views across the playing fields towards Bradda.



View from Bedroom 2



Bedroom 1 4.72m (15'6") x 3.35m (11'0")

A superb room with two uPVC windows to the front. Fitted with a range of bedroom furniture comprising wardrobes, overhead lockers, bedside units, drawers and a dressing table. TV point. Dimmer lighting control.



Register on our Mailing List for ...

SECOND FLOOR

Landing

Smoke detector

Bedroom 4 3.30m (10'10") x 2.57m (8'5")

High angled ceiling to the rear with a double glazed timber framed 'Velux' style window. Television point. A deep recess to the rear (1.45m (4'9") x 1.98m (6'6")) has potential to become a shower room subject to building regulations. Access from this area to eaves storage areas.

Bedroom 3 4.27m (14'0") x 2.74m (9'0")

A double room with a high angled ceiling to the front with two timber framed 'Velux' windows. Access to eaves storage. TV point. Ample space for wardrobes etc.



OUTSIDE



Front

Walled garden with low maintenance gravelled area to one side.

Register on our Mailing List for ...

Rear

A fenced area which has been gravelled for ease of maintenance. Garden shed. Oil tank. External light. Gated access to the parking area.



Communal Parking Area

A shared, block paved area which is accessed from Cronk Road and provides 2 parking spaces to each of the three adjacent properties including number 14.

Services All mains services installed. Oil fired central heating.

Tenure Freehold

Rateable Value Fitted carpets For further information please contact the rates department on (01624) 685661.

Viewings Strictly by appointment with the Agent Quayles Limited.



Register on our Mailing List for ...

FLOOR PLAN

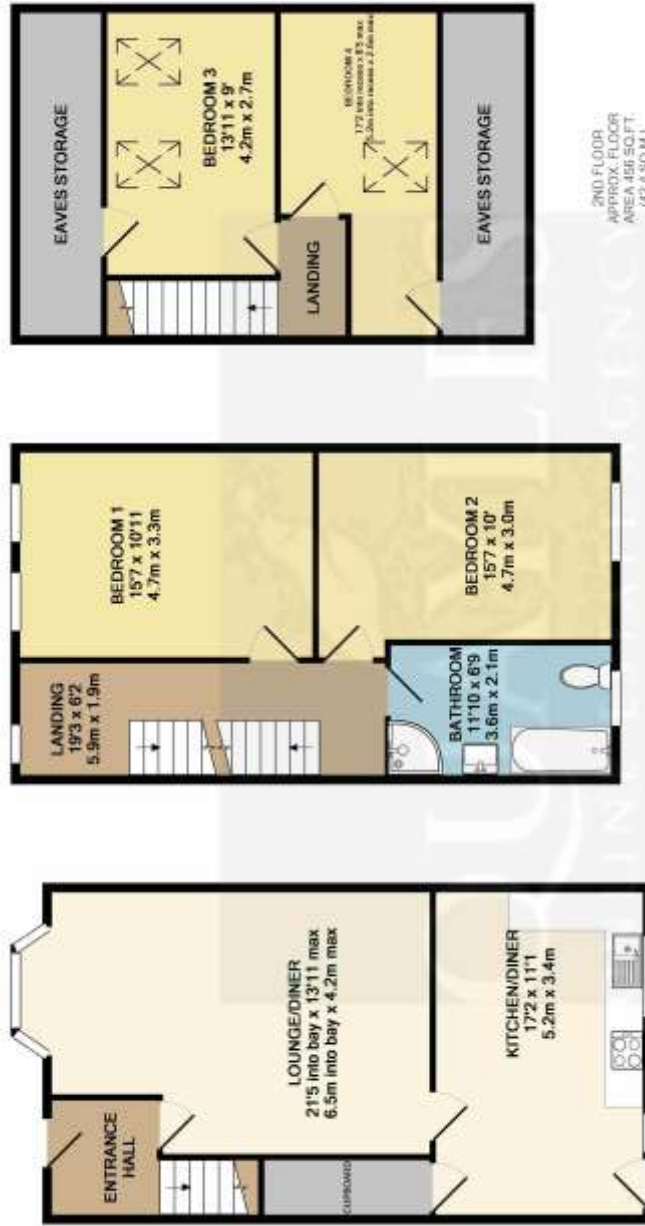

TOTAL APPROX. FLOOR AREA 1531 SQ.FT. (142.2 SQ.M.)

While every effort has been made to ensure the accuracy of the floor plan contained here, measurements of doors, windows, rooms and any other items are approximate and no responsibility is taken for any errors, omissions, or misstatements. This plan is for illustrative purposes only and should be used as such by any prospective purchaser. The fixtures, systems and appliances shown here have not been tested and no guarantee as to their availability or accuracy can be given.

Made with **Intelligent** (CS119)



Whilst all details are believed to be correct neither Quayles Limited, their employees or clients can guarantee their accuracy, nor are they intended to form part of any contract. Our photographs are often taken using a camera with a wide angled lens, whilst this is useful for capturing a larger area it can also result in distortion or partial stretching of an image. All measurements given are approximate. It is not our intention to mislead and therefore we recommend a personal inspection of the property. Prospective purchasers should rely on their own enquiries and legal searches before committing to purchase and advice should be sought from the appropriate professionals where required.



Quayles Limited
1st Floor, The Dovecote
Main Road
Kirk Michael
Isle Of Man
IM6 1AB